

RØDE

MICROPHONES

AI-1 Quickstart Guide

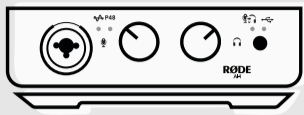

1 Connect AI-1 Interface to computer

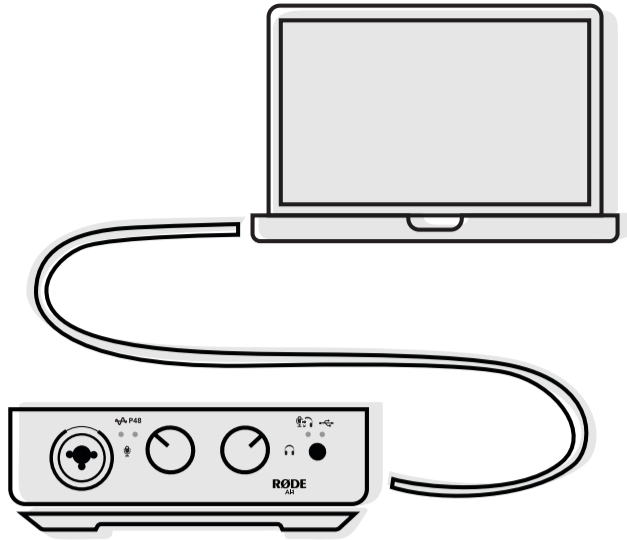

2 Connect microphone or instrument

*cable not included

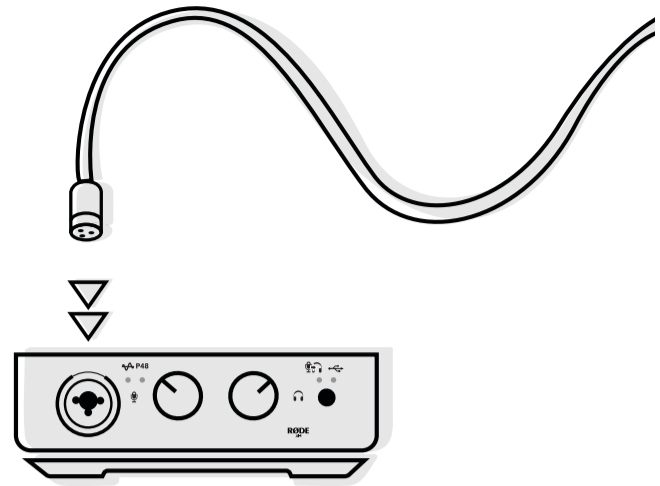

3 Enable Phantom Power (P48)

This is required for condenser microphones

- A Enable P48**
Press left knob to enable, P48 light illuminates red

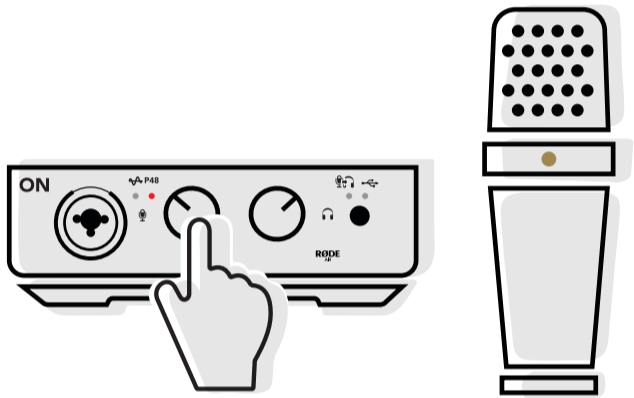

- B Disable P48 for dynamic microphones**
Press left knob to disable, P48 light darkens

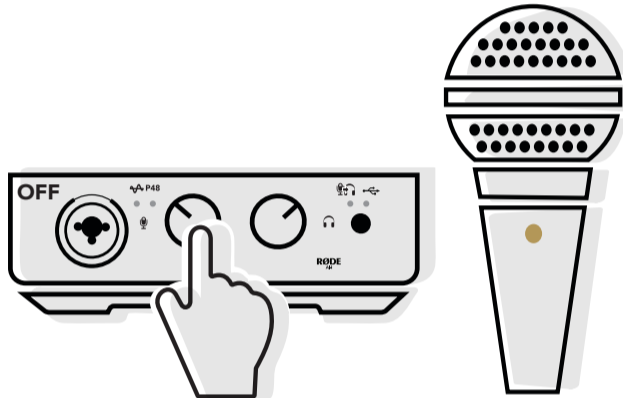

4 Set input level

- A Green is good**

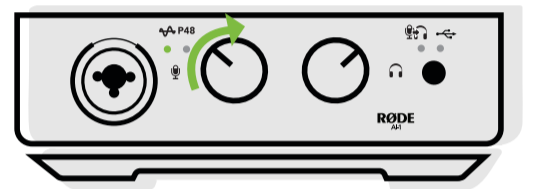

- B Turn down when Red**

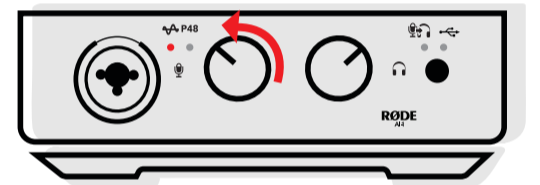

5 Connect headphones, adjust volume

*headphones not included



6 Enable Direct Monitor by pressing right knob

- A ON** - Signal goes from mic direct to headphone output

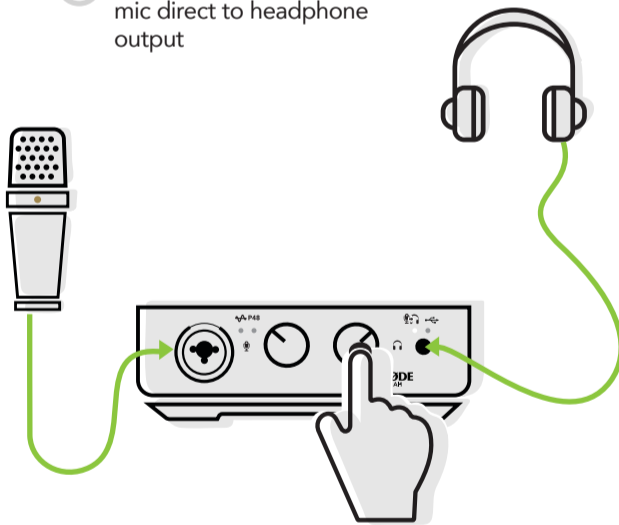

- B OFF** - Signal goes from mic through computer to headphones

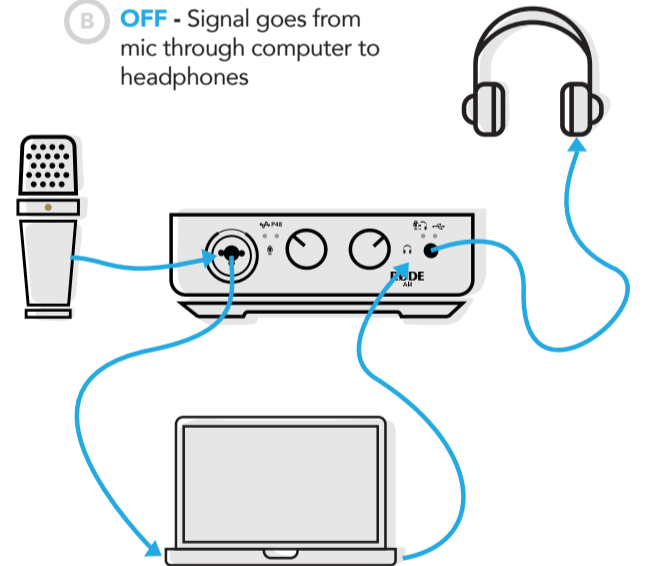

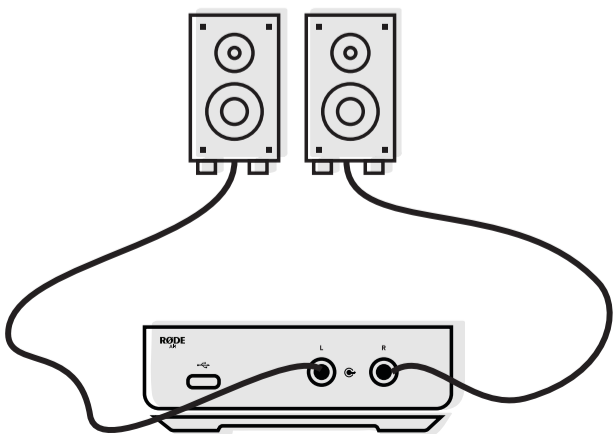

7 If desired, connect powered speakers

*disconnect headphones to activate speaker output



You're now
ready to create!

Love your new product?
Share with us **#rodeai1**

 @rodemic
 @rodemics
 rodemic

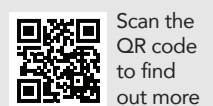

Scan the
QR code
to find
out more

www.rodemic.com