

# Litepanels ASTRA™ 1x1 Communications Modules

## Litepanels ASTRA 1x1 family continues to lead the lighting revolution in form and function.

The ASTRA's popular modular design allows for a variety of lighting control options. Now you can take total control of your lighting with three communications module options compatible with the complete ASTRA family.

### BLUETOOTH COMMUNICATIONS MODULE (900-3519)

Control your lights wirelessly with the Bluetooth Communications Module and Litepanels SmartLite app. Great for independent content creators or studios, the Bluetooth module and Smartlite app is a convenient way to control your lights with your Apple device.

- Used with the Litepanels SmartLite app (available for free download via the Apple App store)
- Allows shooters to control their lights from their Apple iPhone or iPad via Bluetooth and simple pairing process. Once the handheld device pairs with the lights it will remember the light until it is cleared.
- The Bluetooth module allows users to:
  - Control intensity
  - Control color temperature
  - Control fan on/off (not available in ASTRA EP or E series)
  - Group lights together to be controlled at once
  - Have multiple groups of lights
  - Rename fixtures and groups for easy identification
  - View operating temperature in real time
  - View system information such as firmware version



### LITEPANELS SMARTLITE APP



Take total control of your lighting wirelessly with the Litepanels SmartLite app. When paired with the Bluetooth Communications Module, the SmartLite app allows for control of your lighting through your handheld device via Bluetooth. Once paired, the app remembers the fixtures so all you have to do the next time you access to app is connect through your device and you have the control at your fingertips in a matter of seconds.

- Requires iOS 7.0 or later
- Compatible with iPhone, iPad and iPod touch
- Optimized for iPhone 5, iPhone 6 and iPhone 6 Plus
- Free download

### Screenshots from the App:

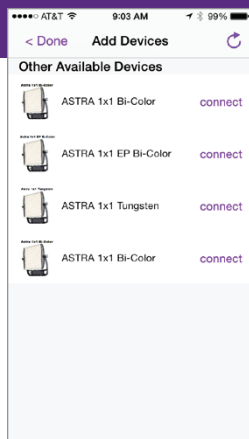

Add a device

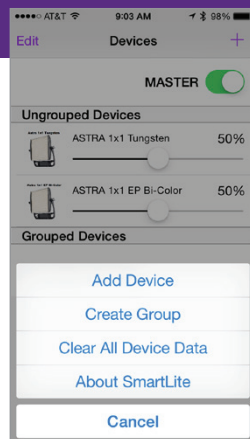

Device menu

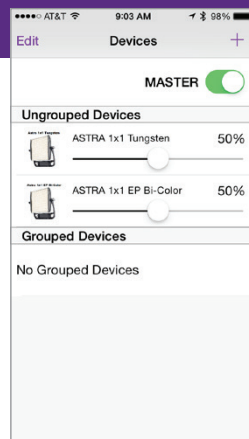

Paired devices

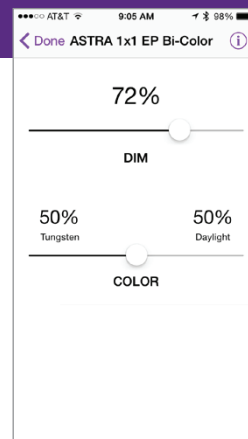

Control of an individual ASTRA 1x1



System information for a single fixture

# Litepanels ASTRA™ 1x1 Communications Modules

## DMX Communication Modules



### 5-PIN XLR COMMUNICATIONS MODULE (900-3502)

Connect your lights to a traditional DMX board with the 5-pin XLR communications module. Featuring male and female 5-Pin XLR connections with a termination switch, the 5-pin XLR module allows fixtures to be controlled individually or together once daisy chained.

### RJ45 COMMUNICATIONS MODULE (900-3501)

Perfect for long runs where traditional XLR cabling can get expensive. The RJ45 communications module features two ports for daisy chain ability and a user friendly LED back lit screen. Pair it with the RJ45 to 5pin XLR adapter cable to connect to a traditional DMX board with 5-pin XLR connections.

- Industry standard DMX-512 protocol
- Male and female connections allows for fixtures to be daisy chained
- Allows control from the DMX control board
  - Intensity
  - Color temperature
  - Fan
  - Group lights together to be controlled at once by daisy chaining

- Backlit display allows users to view information about the light
  - Color temperature mixture
  - Intensity
  - Real time operating temperature
  - Display brightness can be adjusted and blacked out
  - System information (operating temperature, firmware version & more)
  - Set DMX address

## The Litepanels Difference

Full spectrum quality soft light, with visually accurate color temperature  
 The widest variety of LED fixtures available, with flexible AC or DC power options  
 Smooth dimming from 100% to 0, with no noticeable color shift  
 Flicker-free performance at any frame rate or shutter angle  
 Controlled current and thermal management for long LED life  
 Efficient power management delivers low power consumption and enhanced reliability  
 Engineered and designed in Los Angeles, CA

Litepanels, a Vitec Group brand, was founded in 2001 by five professional gaffers and engineers who saw the future and pioneered LED (light emitting diode) lighting for motion pictures, television, and the audio-visual industry. Their Emmy® award-winning technology has now been used on thousands of productions worldwide and is trusted by the world's

leading broadcast organizations. Litepanels continues to expand its suite of flicker-free, color accurate, fully-dimmable soft lights that talent and lighting directors admire. These environmentally friendly fixtures can pay for themselves with power savings and long life, setting a new standard in professional lighting.