

A-E2DT-2N

V-Mount to V-Mount Camera Adaptor with 2 Pin D-Tap DC out



Instruction Manual

Thank you for purchasing the A-E2DT-2N. A-E2DT-2N is a V-Mount to V-Mount plate with 2 a pin D-Tap connector. This product provides a D-Tap output for cameras that do not have a D-Tap. We strongly recommend reading this Instruction Manual on how to best use the A-E2DT-2N. Please keep this manual for your reference. If you have any additional questions, please contact your local IDX office listed at the end of this manual.

Specifications

- Dimensions : 82.5 (W) × 142 (H) × 36 (D) mm
3.24 (W) × 5.59 (H) × 1.4 (D) inches
- Weight : approx , 220g / 0.48 lbs
- Ambient temperature : 32°F~104°F (0°C~40°C)
- Voltage / Amperage : 12-16.8V / 10A MAX
- Maximum D-Tap output : 50W / 4.16A @ 12V

Main connector

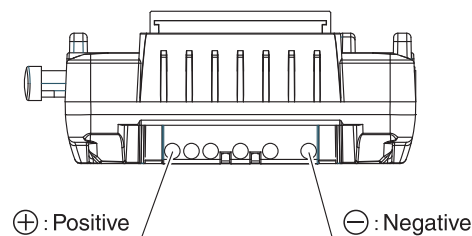

D-Tap connector

※ Please ensure the polarity of the mating D-Tap connector is the same as the illustration below.
Please note the maximum D-Tap output is 50W / 4.16A

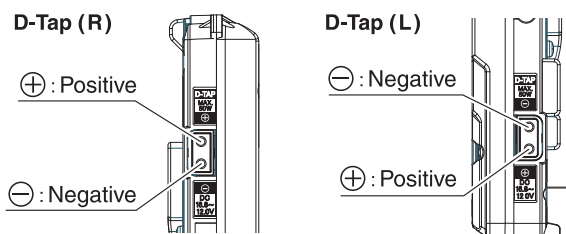

Mounting the A-E2DT-2N to a Camera or Device / Parts Description

- Please attach the V-Lock & camera / device power connector to the camera / device and confirm a firm and complete installation. When connecting an ENDURA battery to the A-E2DT-2N, be sure connect firmly.
- When detaching the plate or battery, press the release button and carefully slide the plate or battery upward (avoid twisting the plate or battery).

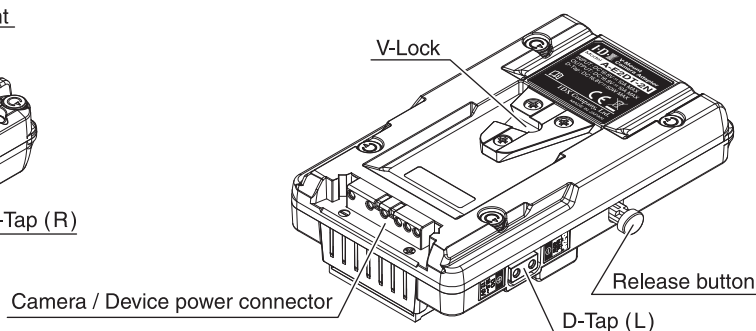
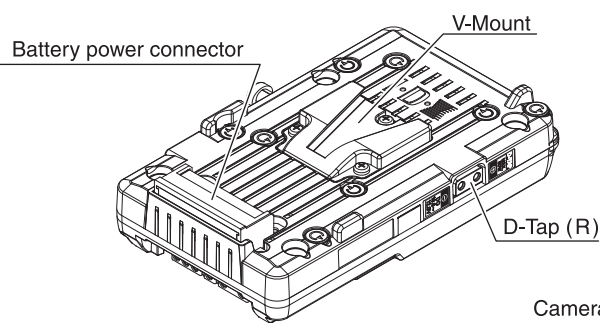

General Notes and Safety

- Do not attempt to open or modify this unit. All work should be carried out by IDX authorized service personnel only.
- Do not attach A-E2DT-2N plates to any non-compatible video camera or equipment as it may cause defect, damage or other incidents. Please read this Instruction Manual carefully before use. (When connecting cables, please check polarity and do not pull the cables hard.)
- When connecting an accessory to a A-E2DT-2N plate, be sure connect firmly. If it is not attached properly, it may result in damage to the unit or even injury to the user.
- Do not expose to, use or place the unit in direct sunlight, extreme dust, water or other hazardous environments.
- A short between the plus (+) and minus (-) terminals may cause fire, electrical shock or other incidents.
- Stop using immediately in case of abnormal smell, leak, color change or case deformity during use.
- The connectors are relatively fragile parts. The A-E2DT-2N may not discharge normally if the terminals become deformed, worn down, or corroded due to long-term use. Please periodically check the connectors for such issues. If you find problems on the terminals (ie. deformation, corrosion, etc.), please stop using the A-E2DT-2N and send it to IDX's service department to replace the terminals.

Design and specification are subject to change without notice.



<http://www.idx.tv>

IDX Company, Ltd. : 6-28-11 Shukugawara, Tamaku, Kawasaki-shi, Kanagawa-ken 214-0021 Japan
Tel : +81-44-850-8801 Fax : +81-44-850-8838 E-mail : idx.japan@idx.tv
IDX System Technology, Inc. : 19001 Harbortgate Way, Suite 105, Torrance, CA 90501 USA
Tel : +1-310-328-2850 Fax : +1-310-328-8202 E-mail : idx.usa@idx.tv
IDX Technology Europe, Ltd. : Unit 9, Langley Park, Waterside Drive, Langley, Berkshire SL3 6AD England
Tel : +44-1753-547692 Fax : +44-1753-546660 E-mail : idx.europe@idx.tv

201509

